



Hammer Drive **blind rivets**



	MATERIALS	FINISH
	aluminium alloy [AlMg 5,0]	polished
	stainless steel A2	polished

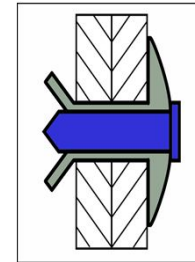
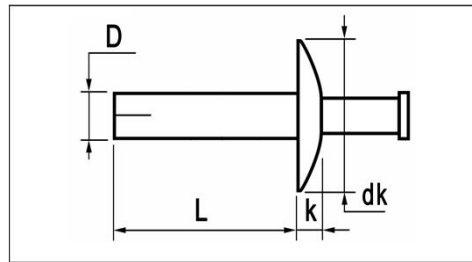

AlMg5,0 / stainless steel A2 Extra Large Head

dimensions in mm

D	L	grip range	article number	dk	k	tensile	shear
	+0,9/-0	min. ~ max.				[N]	[N]
4,8	9,0	4,5 ~ 7,5	HBJXL160-48090				
[+/-0,15]  5,3mm max.	11,0	6,5 ~ 9,0	HBJXL160-48110				
	16,0	11,5 ~ 13,0	HBJXL160-48160				
	20,0	15,5 ~ 17,0	HBJXL160-48200				
	25,0	20,5 ~ 22,0	HBJXL160-48250	16,0	2,6	2.950	4.900
	30,0	25,5 ~ 27,0	HBJXL160-48300	[+/-0,40]	[+/-0,30]		
	35,0	30,5 ~ 32,0	HBJXL160-48350				
	40,0	35,5 ~ 37,0	HBJXL160-48400				
	45,0	40,5 ~ 42,0	HBJXL160-48450				
50,0	45,5 ~ 47,0	HBJXL160-48500					