



# Seal-link blind rivets





	MATERIALS	FINISH
	aluminium alloy	polished
	aluminium alloy	polished

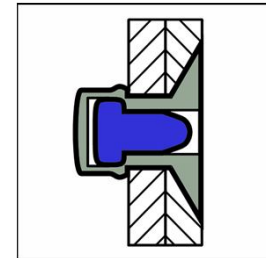
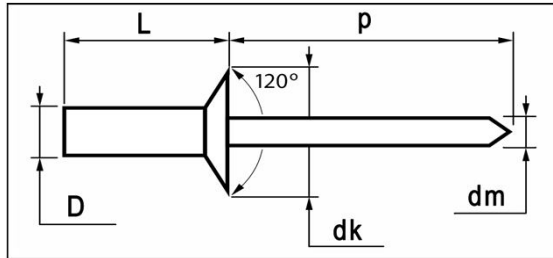

aluminium alloy / aluminium alloy Countersunk Head

dimensions in mm

D	L	grip range	article number	dk	k	dm	p	tensile	shear
	+0,9/-0	min. ~ max.				ref.	min.	[ N ]	[ N ]
<b>3,2</b>	7,5	1,5 ~ 3,5	<b>QLF2-32075</b>						
[+/-0,08]	9,0	3,5 ~ 4,5	<b>QLF2-32090</b>	6,0	1,00	1,70	27	490	450
	10,5	4,5 ~ 6,5	<b>QLF2-32105</b>	[+/-0,4]					
3,3mm									
<b>4,0</b>	9,5	2,0 ~ 5,0	<b>QLF2-40095</b>						
[+/-0,08]	11,0	5,0 ~ 6,5	<b>QLF2-40110</b>	7,5	1,20	2,20	27	820	580
	12,5	6,0 ~ 8,0	<b>QLF2-40125</b>	[+/-0,5]					
4,1mm									
<b>4,8</b>	9,5	2,5 ~ 4,5	<b>QLF2-48095</b>						
[+/-0,08]	11,0	4,5 ~ 6,0	<b>QLF2-48110</b>						
	12,5	6,0 ~ 7,5	<b>QLF2-48125</b>	9,0	1,30	2,65	27	1.120	900
4,9mm	14,0	7,5 ~ 9,0	<b>QLF2-48140</b>	[+/-0,5]					
	15,5	9,0 ~ 10,5	<b>QLF2-48155</b>						
	17,0	10,5 ~ 12,0	<b>QLF2-48170</b>						
	19,0	12,0 ~ 14,0	<b>QLF2-48190</b>						