



Riv-link standard blind rivets





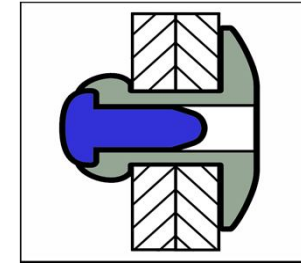
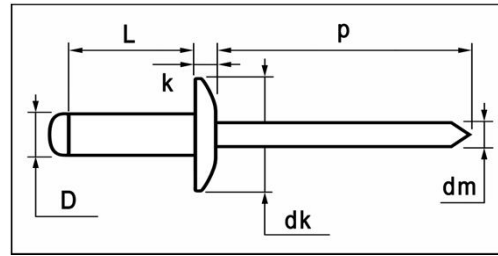

	MATERIALS	FINISH
	aluminium alloy [AlMg 3,5]	polished
	carbon steel	zinc plated



AlMg3,5 / steel Large Head

dimensions in mm

D	L	grip range	article number	dk	k	dm	p	tensile	shear
	+0,9/-0	min. ~ max.			max.	ref.	min.	[N]	[N]
3,2	6,0	1,5 ~ 3,0	H3KL095-32060						
[+0,08/-0,10]	8,0	3,0 ~ 5,0	H3KL095-32080						
	10,0	5,0 ~ 7,0	H3KL095-32100	9,5	2,0	1,75	27	980	760
3,3mm	12,0	7,0 ~ 9,0	H3KL095-32120	[+0/-0,5]					
	14,0	9,0 ~ 11,0	H3KL095-32140						
4,0	6,0	1,0 ~ 2,0	H3KL120-40060						
[+0,08/-0,15]	8,0	2,0 ~ 4,0	H3KL120-40080						
	10,0	4,0 ~ 6,0	H3KL120-40100	12,0	2,5	2,10	27	1.600	1.200
4,1mm	12,0	6,0 ~ 8,0	H3KL120-40120	[+0/-0,5]					
	14,0	8,0 ~ 10,0	H3KL120-40140						
	16,0	10,0 ~ 12,0	H3KL120-40160						
4,8	8,0	2,0 ~ 3,5	H3KL140-48080						
[+0,08/-0,15]	10,0	3,5 ~ 5,5	H3KL140-48100						
	12,0	5,5 ~ 7,5	H3KL140-48120						
4,9	14,0	7,5 ~ 9,5	H3KL140-48140						
	16,0	9,0 ~ 11,0	H3KL140-48160						
	18,0	11,0 ~ 13,0	H3KL140-48180	14,0	2,5	2,70	27	2.230	1.690
	20,0	13,0 ~ 15,0	H3KL140-48200	[+0/-0,5]					
	22,0	15,0 ~ 17,0	H3KL140-48220						
	25,0	17,0 ~ 20,0	H3KL140-48250						
	28,0	20,0 ~ 23,0	H3KL140-48280						
	30,0	23,0 ~ 24,5	H3KL140-48300						
	35,0	24,5 ~ 29,0	H3KL140-48350						
5,0	8,0	2,0 ~ 3,5	H3KL140-50080						
[+0,08/-0,15]	10,0	3,5 ~ 5,5	H3KL140-50100						
	12,0	5,5 ~ 7,5	H3KL140-50120	14,0	2,5	2,70	27	2.500	2.000
5,1mm	14,0	7,5 ~ 9,5	H3KL140-50140	[+0/-0,5]					
	16,0	9,0 ~ 11,0	H3KL140-50160						
	18,0	11,0 ~ 13,0	H3KL140-50180						
	20,0	13,0 ~ 15,0	H3KL140-50200						