

Riv-link standard blind rivets

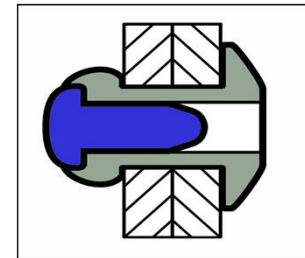

MATERIALS	FINISH
aluminium alloy [AlMg 3,5]	polished
carbon steel	zinc plated

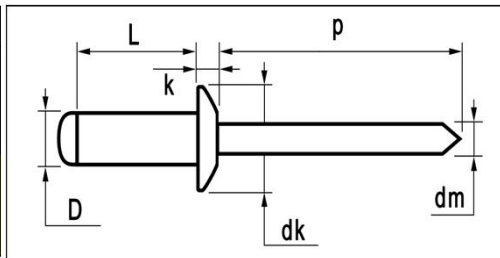

AlMg3,5 / steel Dome Head

dimensions in mm

D	L	grip range	article number	dk	k	dm	p	tensile	shear
	+0,9/-0	min. ~ max.				ref.	min.	[N]	[N]
4,0 [+0,08/-0,15] 4,1mm	6,0	1,0 ~ 2,0	H3K-40060						
	8,0	2,0 ~ 4,0	H3K-40080						
	10,0	4,0 ~ 6,0	H3K-40100						
	12,0	6,0 ~ 8,0	H3K-40120						
	14,0	8,0 ~ 10,0	H3K-40140	8,0	1,0	2,10	27	1.600	1.200
	16,0	10,0 ~ 12,0	H3K-40160	[+0/-1,0]	[+/-0,30]				
	18,0	12,0 ~ 14,0	H3K-40180						
	20,0	14,0 ~ 15,5	H3K-40200						
	23,0	15,5 ~ 18,0	H3K-40230						
25,0	18,0 ~ 20,0	H3K-40250							
4,8 [+0,08/-0,15] 4,9	6,0	1,0 ~ 2,0	H3K-48060						
	8,0	2,0 ~ 3,5	H3K-48080						
	10,0	3,5 ~ 5,5	H3K-48100						
	12,0	5,5 ~ 7,5	H3K-48120						
	14,0	7,5 ~ 9,5	H3K-48140						
	16,0	9,0 ~ 11,0	H3K-48160						
	18,0	11,0 ~ 13,0	H3K-48180	9,5	1,1	2,70	27	2.230	1.690
	20,0	13,0 ~ 15,0	H3K-48200	[+0/-1,0]	[+/-0,30]				
	22,0	15,0 ~ 17,0	H3K-48220						
	25,0	17,0 ~ 20,0	H3K-48250						
5,0 [+0,08/-0,15] 5,1mm	6,0	1,0 ~ 2,0	H3K-50060						
	8,0	2,0 ~ 3,5	H3K-50080						
	10,0	3,5 ~ 5,5	H3K-50100						
	12,0	5,5 ~ 7,5	H3K-50120						
	14,0	7,5 ~ 9,5	H3K-50140						
	16,0	9,0 ~ 11,0	H3K-50160						
	18,0	11,0 ~ 13,0	H3K-50180	9,5	1,1	2,70	27	2.500	2.000
	20,0	13,0 ~ 15,0	H3K-50200	[+0/-1,0]	[+/-0,30]				
	25,0	15,0 ~ 20,0	H3K-50250						
6,0 [+0,08/-0,15] 6,1mm	8,0	1,0 ~ 3,0	H3K-60080						
	10,0	3,0 ~ 4,5	H3K-60100						
	12,0	4,5 ~ 6,0	H3K-60120						
	14,0	6,0 ~ 8,5	H3K-60140						
	16,0	8,5 ~ 10,5	H3K-60160	12,0	1,5	3,60	31	3.900	2.500
	18,0	10,5 ~ 12,0	H3K-60180	[+0/-1,5]	[+/-0,40]				
	22,0	12,0 ~ 16,0	H3K-60220						
6,4 [+0,08/-0,15] 6,5mm	10,0	1,0 ~ 3,5	H3K-64100						
	12,0	3,5 ~ 5,5	H3K-64120						
	15,0	5,5 ~ 8,5	H3K-64150						
	18,0	8,5 ~ 11,5	H3K-64180	13,0	2,0	3,85	31	4.090	3.120
	22,0	11,5 ~ 15,5	H3K-64220	[+0/-1,5]	[+/-0,40]				
	30,0	19,0 ~ 23,0	H3K-64300						