



Riv-link standard blind rivets





	MATERIALS	FINISH
	aluminium alloy [AlMg 2,5]	polished
	carbon steel	zinc plated

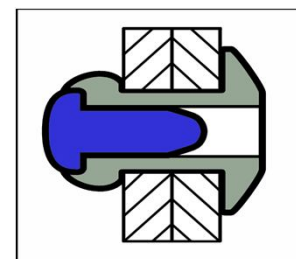
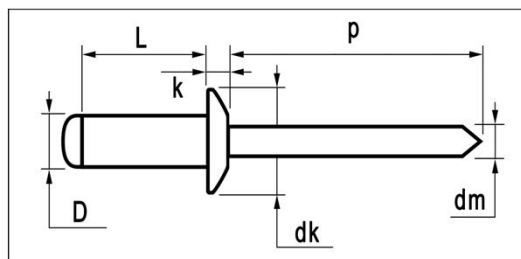

AlMg2,5 / steel Dome Head

dimensions in mm

D	L	grip range	article number	dk	k	dm	p	tensile	shear
	+0,9/-0	min. ~ max.				ref.	min.	[N]	[N]
2,4	4,0	~ 2,0	H2K-24040						
[+0,08/-0,10]	6,0	1,5 ~ 3,5	H2K-24060	5,0	0,7	1,45	27	353	315
 2,5mm	8,0	3,5 ~ 5,5	H2K-24080	[+0/-0,7]	[+/-0,15]				
	10,0	5,5 ~ 7,5	H2K-24100						
3,0	4,0	~ 1,5	H2K-30040						
[+0,08/-0,10]	6,0	1,5 ~ 3,5	H2K-30060						
 3,1mm	8,0	3,5 ~ 5,5	H2K-30080	6,5	0,8	1,75	27	810	620
	10,0	5,5 ~ 7,5	H2K-30100	[+0/-0,7]	[+/-0,20]				
	12,0	7,5 ~ 9,5	H2K-30120						
	14,0	9,0 ~ 11,0	H2K-30140						
	16,0	11,0 ~ 13,0	H2K-30160						
3,2	4,0	~ 1,5	H2K-32040						
[+0,08/-0,10]	6,0	1,5 ~ 3,0	H2K-32060						
 3,3mm	8,0	3,0 ~ 5,0	H2K-32080	6,5	0,8	1,75	27	980	760
	10,0	5,0 ~ 7,0	H2K-32100	[+0/-0,7]	[+/-0,20]				
	12,0	7,0 ~ 9,0	H2K-32120						
	14,0	9,0 ~ 11,0	H2K-32140						
	16,0	11,0 ~ 12,5	H2K-32160						
	18,0	12,5 ~ 14,5	H2K-32180						
	20,0	14,5 ~ 16,5	H2K-32200						