



# Riv-link standard blind rivets





	MATERIALS	FINISH
	carbon steel	zinc plated
	carbon steel	zinc plated

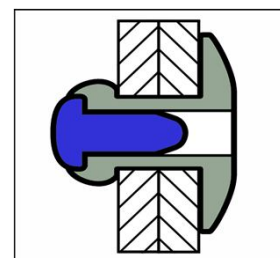
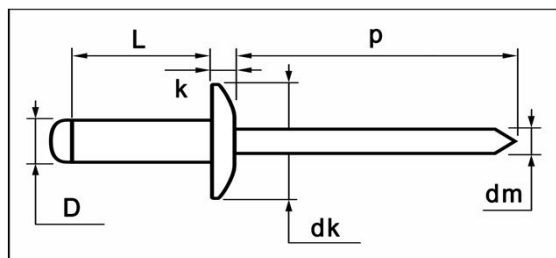

## steel / steel Large Head

dimensions in mm

D	L	grip range	article number	dk	k	dm	p	tensile	shear
	+0,9/-0	min. ~ max.			max.	ref.	min.	[ N ]	[ N ]
<b>3,2</b>	8,0	3,5 ~ 5,5	<b>GKL095-32080</b>						
[+0,08/-0,10]	10,0	5,5 ~ 7,5	<b>GKL095-32100</b>	9,5	2,0	2,00	27	1.285	1.100
	12,0	7,5 ~ 9,5	<b>GKL095-32120</b>	[+0/-0,7]					
3,3mm	14,0	9,0 ~ 11,0	<b>GKL095-32140</b>						
<b>4,0</b>	8,0	2,0 ~ 4,0	<b>GKL120-40080</b>						
[+0,08/-0,15]	10,0	4,0 ~ 6,0	<b>GKL120-40100</b>						
	12,0	6,0 ~ 8,0	<b>GKL120-40120</b>	12,0	2,5	2,50	27	2.200	1.700
	14,0	8,0 ~ 10,0	<b>GKL120-40140</b>	[+0/-1,0]					
4,1mm	16,0	10,0 ~ 12,0	<b>GKL120-40160</b>						
<b>4,8</b>	10,0	3,5 ~ 5,5	<b>GKL140-48100</b>						
[+0,08/-0,15]	12,0	5,5 ~ 7,5	<b>GKL140-48120</b>						
	14,0	7,5 ~ 9,5	<b>GKL140-48140</b>						
	16,0	9,0 ~ 11,0	<b>GKL140-48160</b>	14,0	2,5	2,90	27	3.100	2.900
	18,0	11,0 ~ 13,0	<b>GKL140-48180</b>	[+0/-1,0]					
4,9mm	20,0	13,0 ~ 15,0	<b>GKL140-48200</b>						
	22,0	15,0 ~ 17,0	<b>GKL140-48220</b>						