

Riv-link standard blind rivets

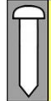

	MATERIALS	FINISH
	carbon steel	zinc plated
	carbon steel	zinc plated

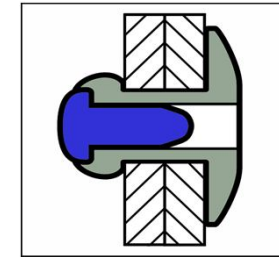
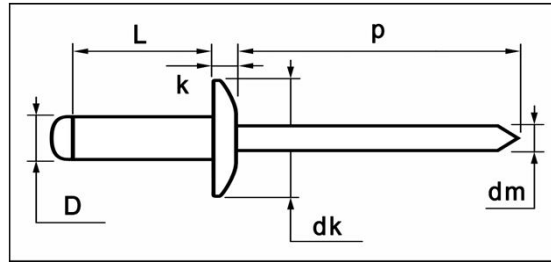

steel / steel Extra Large Head

dimensions in mm

D	L	grip range	article number	dk	k	dm	p	tensile	shear
	+0,9/-0	min. ~ max.			max.	ref.	min.	[N]	[N]
4,8	10,0	3,5 ~ 5,5	GKL160-48100						
[+0,08/-0,15]	12,0	5,5 ~ 7,5	GKL160-48120						
	14,0	7,5 ~ 9,5	GKL160-48140						
4,9mm	16,0	9,0 ~ 11,0	GKL160-48160	16,0	2,5	2,90	27	3.100	2.900
	18,0	11,0 ~ 13,0	GKL160-48180	[+0/-1,0]					
	20,0	13,0 ~ 15,0	GKL160-48200						
	22,0	15,0 ~ 17,0	GKL160-48220						