

Multi-link blind rivets

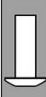

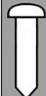

	MATERIALS	FINISH
	aluminium alloy [AlMg 2,5]	polished
	stainless steel A2	polished

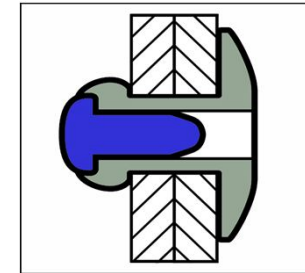
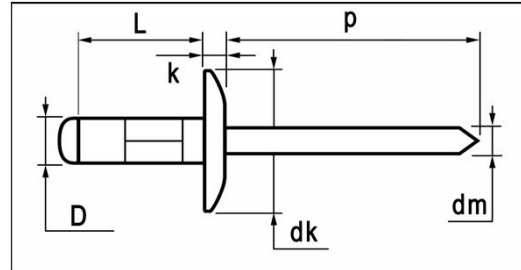

AlMg2,5 / stainless steel A2 Large Head

dimensions in mm

D	L	grip range min. ~ max.	article number	dk	k max.	dm ref.	p min.	tensile [N]	shear [N]
3,2	8,0	0,5 ~ 5,0	H2BSL095-32080						
[+0,05/-0,13]	9,5	2,0 ~ 6,5	H2BSL095-32095	9,5	2,00	1,75	27	980	760
	12,5	5,0 ~ 9,5	H2BSL095-32125	[+0/-0,5]					
3,3 ~ 3,5mm	16,0	8,5 ~ 13,0	H2BSL095-32160						
4,0	9,5	1,0 ~ 6,0	H2BSL120-40095						
[+0,05/-0,13]	12,5	4,0 ~ 9,0	H2BSL120-40125	12,0	2,50	2,10	27	1.600	1.200
	17,0	8,5 ~ 13,5	H2BSL120-40170	[+0/-0,5]					
4,1 ~ 4,3mm	20,0	11,5 ~ 16,5	H2BSL120-40200						
4,8	10,0	1,0 ~ 5,0	H2BSL140-48100						
[+0,05/-0,13]	12,5	3,0 ~ 7,5	H2BSL140-48125	14,0	2,50	2,70	27	2.350	1.690
	15,0	5,1 ~ 10,0	H2BSL140-48150	[+0/-0,5]					
4,9 ~ 5,2mm	17,0	6,9 ~ 12,0	H2BSL140-48170						
	20,0	10,0 ~ 15,0	H2BSL140-48200						